

- GENERAL NOTES:**
1. ALL MATERIALS AND METHODS OF CONSTRUCTION SHALL CONFORM TO TOWN OF KNIGHTDALE AND NCDOT STANDARDS AND SPECIFICATIONS.
 2. BOUNDARY AND EXISTING SITE INFORMATION TAKEN FROM DIGITAL FILES PROVIDED BY ELINGBURG LAND SURVEY COMPANY.
 3. TOPOGRAPHIC INFORMATION FOR PHASES 1, 2 AND 3 WERE TAKEN FROM A DIGITAL FILE PROVIDED BY ELINGBURG LAND SURVEY COMPANY AND MERGED WITH TOPOGRAPHIC INFORMATION TAKEN FROM WAKE COUNTY GIS DIGITAL FILES.
 4. THIS PROPERTY IS LOCATED IN SPECIAL FLOOD HAZARD AREAS PER FLOOD INSURANCE RATE MAP #1720173300 (EFFECTIVE DATE MAY 2, 2006).
 5. WETLAND AND NEUSE RIVER BUFFER DELINEATIONS WERE DETERMINED BY SOL & ENVIRONMENTAL CONSULTANTS, INC.
 6. ALL NECESSARY PERMITS SHALL BE OBTAINED FROM WAKE COUNTY, THE ARMY CORPS OF ENGINEERS OR OTHER AUTHORIZED AGENCIES PRIOR TO CONSTRUCTION DRAWING APPROVAL IN THE AFFECTED PHASE.
 7. THE RIGHT-OF-WAY SHALL BE CLEARED AND GRUBBED WITHIN 50' OF ANY INTERSECTION.
 8. WITHIN THE AREA OF DEFINED SIGHT TRIANGLE, THERE SHALL BE NO SIGHT OBSTRUCTING OR PARTLY OBSTRUCTING WALL, FENCE, SIGN, FOLIAGE, BEARING, OR PARKED VEHICLES BETWEEN THE HEIGHTS OF TWENTY-FOUR (24) INCHES AND EIGHT (8) FEET ABOVE THE CURB LINE ELEVATION OR THE NEAREST TRAVELED WAY IF NO CURBING EXISTS.
 9. THE AREAS IDENTIFIED AS NEUSE RIVER RIPARIAN BUFFER SHALL BE MAINTAINED IN PERPETUITY IN THEIR NATURAL OR MITIGATED CONDITION. NO PERSON OR ENTITY SHALL FILL, GRAZE, EXCAVATE, OR PERFORM ANY OTHER LAND-DISTURBING ACTIVITIES, NOR CUT, REMOVE, OR HARM ANY VEGETATION, NOR CONSTRUCT ANY STRUCTURES NOR ADD ANY ADDITIONAL IMPERVIOUS SURFACE, NOR ALLOW ANIMAL GRAZING OR WATERING OR ANY OTHER AGRICULTURAL USE ON SUCH PROTECTED AREAS WITHOUT WRITTEN AUTHORIZATION OF THE DIVISION OF WATER QUALITY (DWQ) OR COMPLIANCE WITH THE RIPARIAN BUFFER PROTECTION RULES (15A NCAC 2B .0223 OR .0229). THIS COVENANT IS TO RUN WITH THE LAND, AND SHALL BE BINDING ON THE OWNER, AND ALL PARTIES.
 10. ALL LOTS SHALL BE LOCATED OUTSIDE OF THE NEUSE RIVER BUFFERS.
 11. ALL AREA OUTSIDE OF LOTS IS OPEN SPACE THAT SHALL BE DEDICATED AND MAINTAINED BY THE HOA.
 12. NO CHANGES TO ANY ASPECT OF THIS DEVELOPMENT PLAN, INCLUDING BUT NOT LIMITED TO LANDSCAPING, GRADING OR UTILITIES, WILL BE MADE WITHOUT THE APPROVAL OF THE TECHNICAL REVIEW COMMITTEE OF THE TOWN OF KNIGHTDALE.
 13. THIS PLAN HAS BEEN REVIEWED FOR COMPLIANCE WITH TOWN OF KNIGHTDALE UNIFIED DEVELOPMENT ORDINANCE. THIS PLAN HAS NOT BEEN REVIEWED FOR COMPLIANCE WITH PRIVATE RESTRICTIVE COVENANTS WHICH MAY REQUIRE A LARGER LOT SIZE AND GREATER SETBACKS THAN THOSE REQUIRED BY THE TOWN OF KNIGHTDALE. THE PROPERTY OWNER IS RESPONSIBLE FOR ENSURING THAT THIS SUBDIVISION COMPLIES WITH ALL PRIVATE RESTRICTIVE COVENANTS.
 14. MASS GRADING OF DEVELOPMENT IS NOT PERMITTED.
 15. TOWN OF KNIGHTDALE AND WAKE COUNTY ENGINEER WILL PREPARE THE STREET FIXTURE LIGHTING PLAN. THE DEVELOPER WILL BE RESPONSIBLE FOR ALL COSTS RELATED TO STREET LIGHTING INSTALLATION.
 16. THE HOME BUILDERS WILL NEED TO ENSURE THAT THEIR BUILDING ELEVATIONS COMPLY WITH THE REQUIREMENTS OF THE APPROVED UAA AND WMAP.
 17. NO DRIVEWAYS ARE ALLOWED ON THE MAIN STREET CROSS SECTION.
 18. THE FIRST PHASE OF THE ACTIVE OPEN SPACE AMENITY MUST BE COMPLETED BY JUNE 30, 2018.
 19. OPEN SPACE AREAS ARE TO BE IMPROVED BASED ON HOMEOWNER AND DEVELOPER CONCURRENCE WITH TOWN OF KNIGHTDALE.
 20. DRAINAGE EASEMENT TYPE, WHETHER PUBLIC OR PRIVATE, WILL BE DETERMINED WITH THE REVIEW OF THE RECORD PLAT.

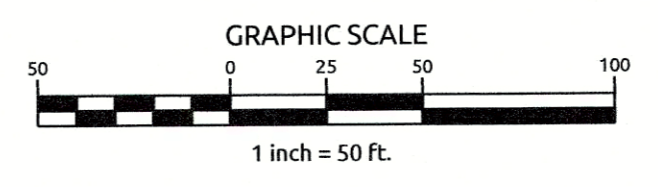
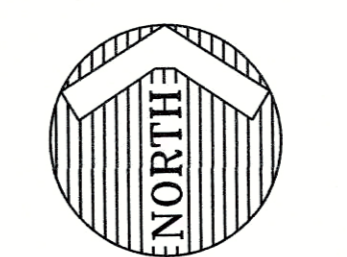
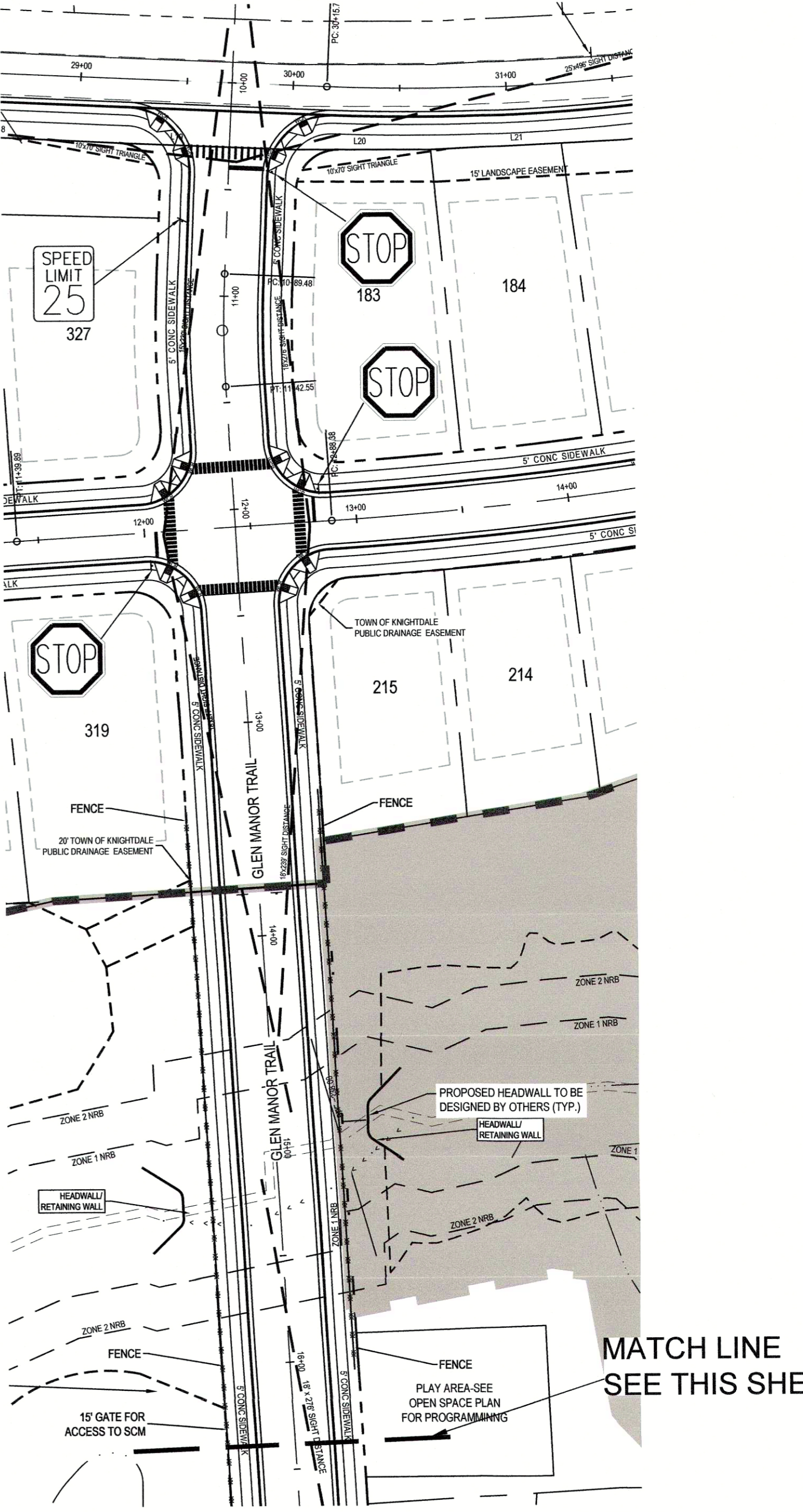

NOTE:
SEE OVERALL SITE PLAN (SHEET 2.0) FOR SIGHT DISTANCE CALCULATIONS.

REVIEW CERTIFICATION BY THE TOWN OF KNIGHTDALE

THIS DRAWING HAS BEEN REVIEWED BY THE ENGINEER FOR THE TOWN OF KNIGHTDALE, AND TO THE BEST OF MY KNOWLEDGE AND BELIEF, IT CONFORMS TO THE REQUIREMENTS ESTABLISHED IN THE STANDARD SPECIFICATIONS OF THE TOWN OF KNIGHTDALE.

BY: *Small* DATE: 7-27-2020
TOWN ENGINEER

THESE PLANS ARE APPROVED BY THE TOWN OF KNIGHTDALE AND SERVE AS CONSTRUCTION PLANS FOR THIS PROJECT.

BY: *Small* DATE: 7/27/20
ADMINISTRATOR

WithersRavenel
Engineers | Planners

127 S. Wilmington Street | Suite 200 | Raleigh, NC 27601 | 919.469.2840 | license #: C-068321
www.withersravenel.com

**GLENMERE SUBDIVISION,
PHASE 6-7**

PHASE 6 SITE PLAN

KNIGHTDALE, NORTH CAROLINA

Job No. 02150059	Drawn By: EJW
Date: 07/23/2018	Designer: KLU

Doc No. **18488**

Kenneth L. Jesnick 7/13/2020
NORTH CAROLINA PROFESSIONAL ENGINEER
SEAL 18488

Revisions	Comments	Date
1	AS PER TOX AND COR REVIEW COMMENTS	01/21/20
2	AS PER TOX AND COR REVIEW COMMENTS	04/28/20
3	AS PER WAKE COUNTY REVIEW COMMENTS	05/20/20
4	AS PER TOX AND COR REVIEW COMMENTS	06/19/20
5	FINAL FOR SIGNATURE	07/13/20

Sheet No.
2.1

K:\13.15-02001-10000-Governor\CAD\Phase 6 & 7\Drawings - Master\Site Plan.dwg, Monday, July 13, 2020 2:07:02 PM - JESNICK, KEN